







**Extension et restructuration de la direction interrégionale
de la protection judiciaire de jeunesse sud-ouest**
8, rue Poitevin
33000 Bordeaux

MAITRE D'OUVRAGE	Ministère de la Justice - Délégation Interrégionale du Secrétariat Général Sud-Ouest 13 rue Letellier - CS92100 - 33072 Bordeaux cedex tel : 05 40 45 24 00		
ARCHITECTE DPLG	AGENCE D'ARCHITECTURE F. LAFFITTE 141, av. Montaigne 33160 St Médard en Jalles Tel 05 56 70 04 40 mail: laffitte.architecte@orange.fr	 L'affitte AGENCE D'ARCHITECTURE 141 AV MONTAIGNE 33160 ST MÉDARD EN JALLES 05 56 70 04 40 LAFFITTE.ARCHITECTE@ORANGE.FR	
BUREAU D'ETUDES T.C.E	ACTIONM 1, rue du 503ème Régiment du Train 33127 Martignas sur Jalle Tel: 06 59 05 79 46 Mail: b.bufferand@actionm.fr	 ACTIONM	
BUREAU D'ETUDES ACOUSTIQUES	IDB ACOUSTIQUE 75 avenue Léon Blum 33600 Pessac Tel 05 56 07 55 55 mail: idb@idb-acoustique.com	 idB	
BUREAU DE CONTROLE	APAVE Avenue Gay Lussac BP3 33370 Artigues Près Bordeaux Tel 05 56 77 38 46 mail: frederique.lauzeille@apave.com	 apave	
COORDONATEUR SPS	ELYFEC 32, allée de Boutaut 33070 Bordeaux Tel 06 78 11 28 11 mail: patrice.aprelon@elyfec.fr	 ELYFEC	

Date: oct. 2025	ech: 1/100	BÂTIMENT DME CARNET DE DÉTAILS	
DCE	A 309		
PHASE	DATE	INDICE	MODIFICATIONS

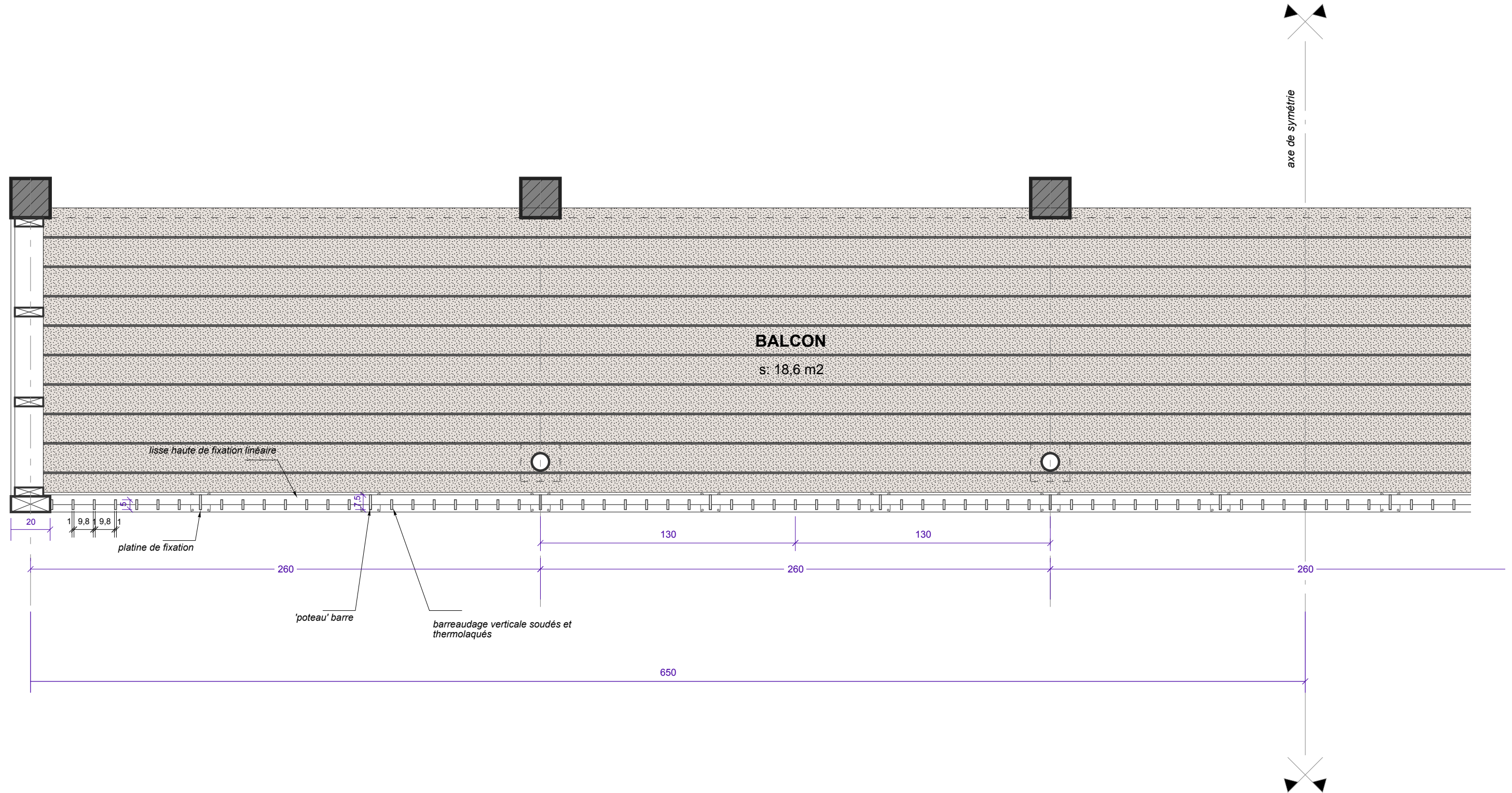

VUE EN PLAN

DETAIL DE PRINCIPE - éch: 1/20
BALCON + GARDE CORPS

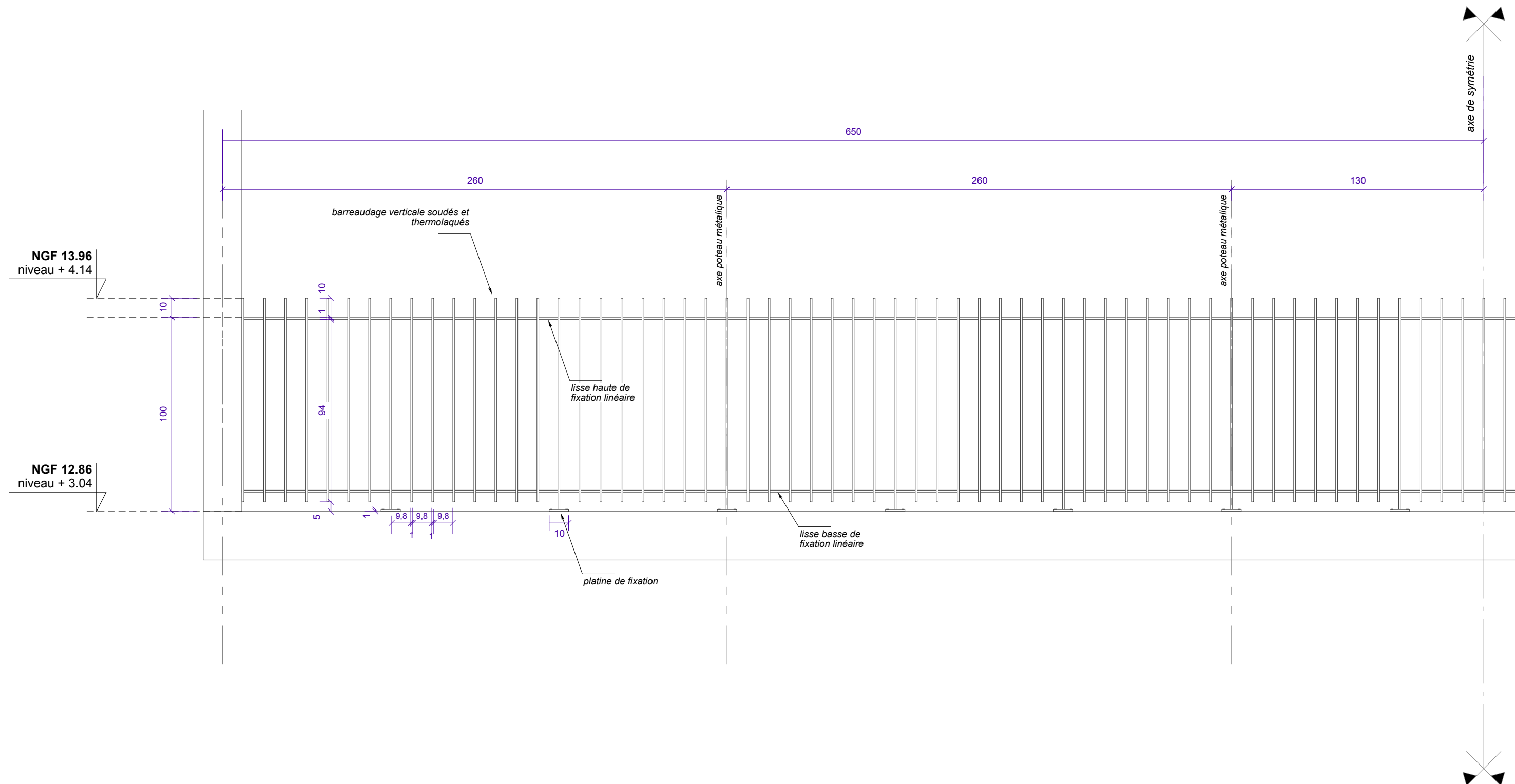

VUE EN ELEVATION

DETAIL DE PRINCIPE - éch: 1/20
BALCON + GARDE CORPS

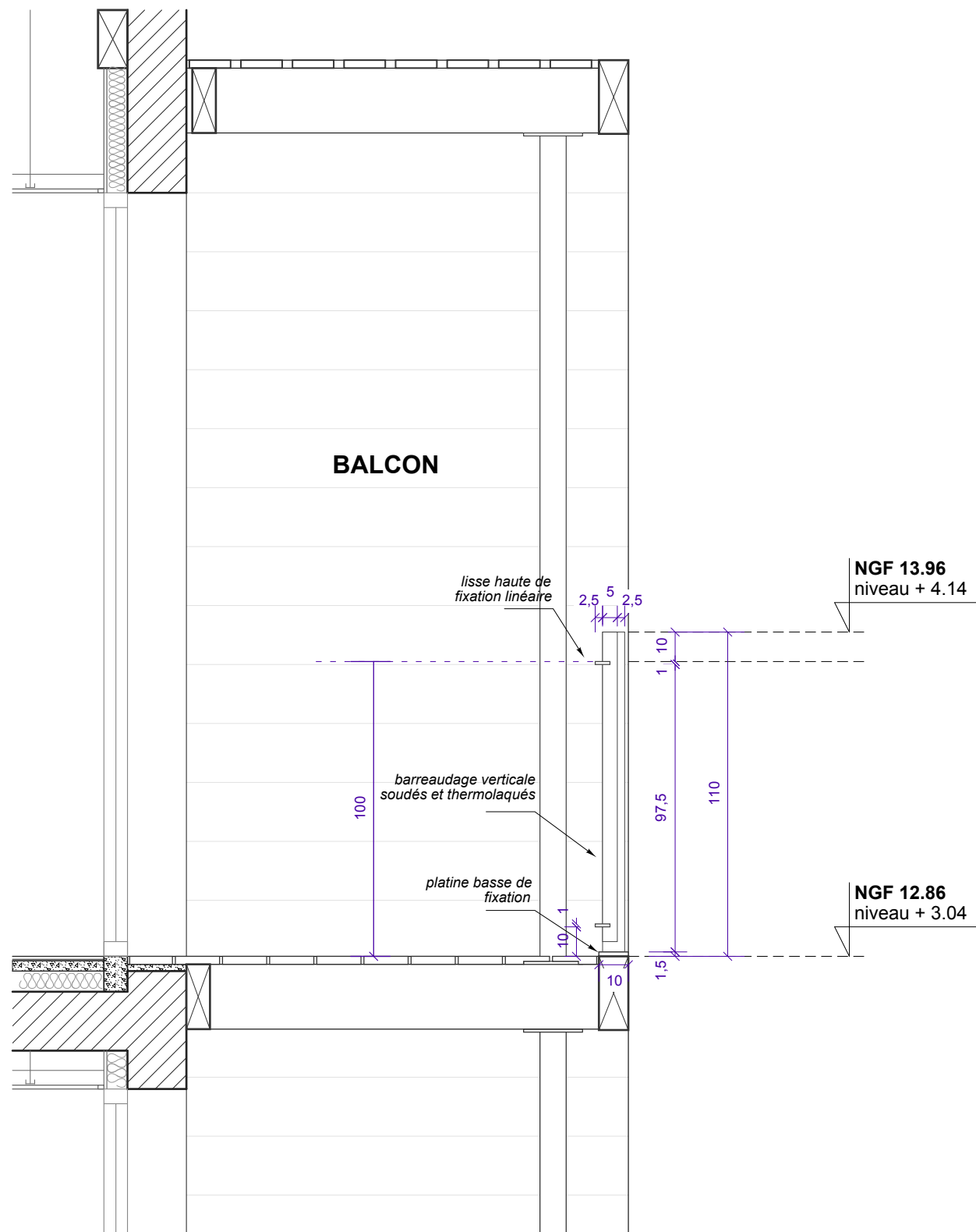

VUE EN COUPE - PORTAIL

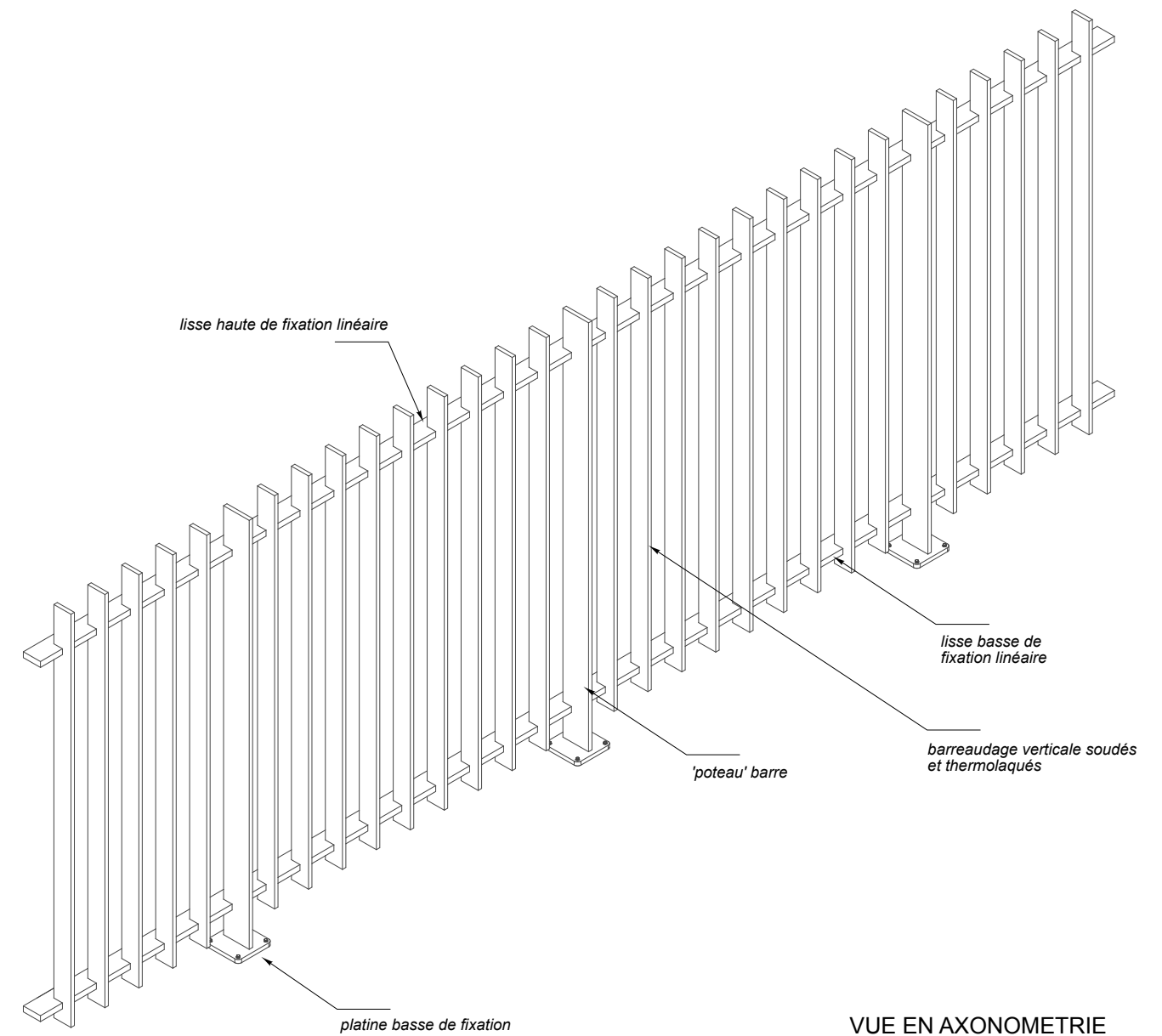

VUE EN AXONOMETRIE

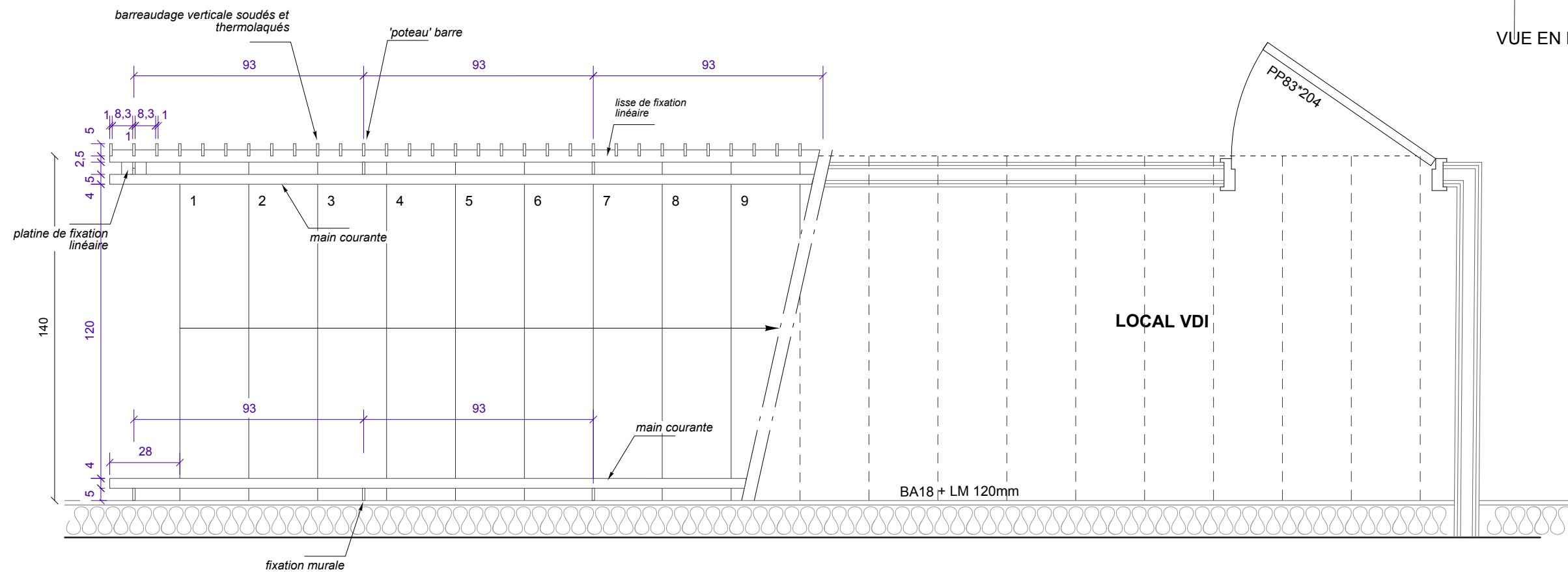
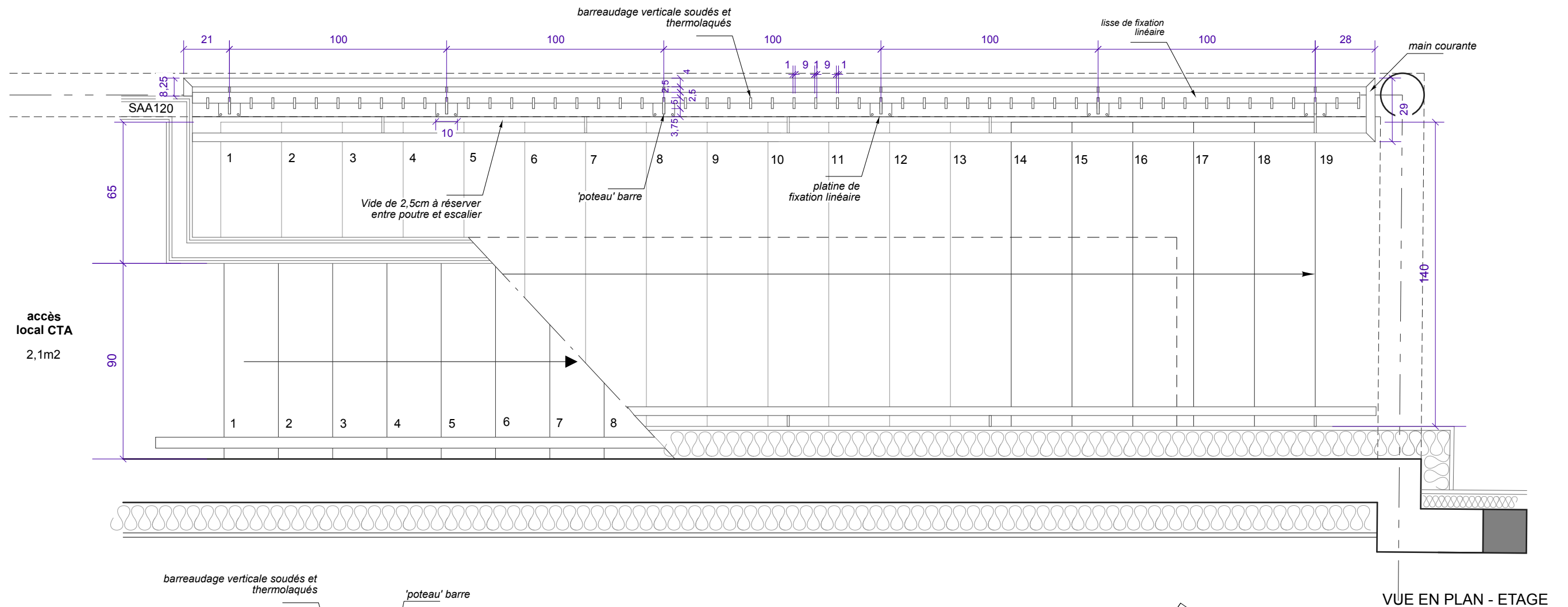

DETAIL DE PRINCIPE - éch: 1/20
ESCALIER + GARDE CORPS

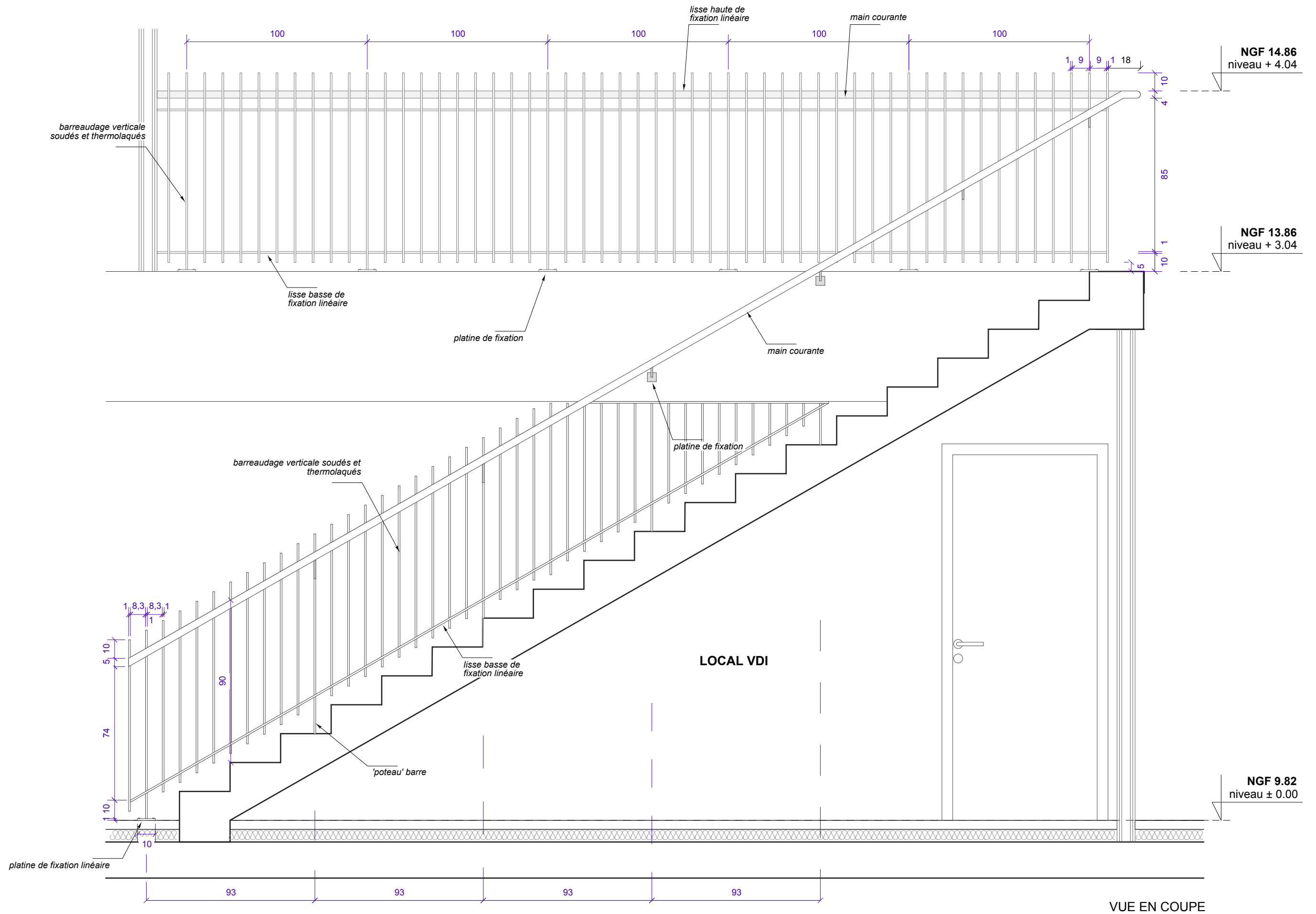

DETAIL DE PRINCIPE - éch: 1/20
BALCON + GARDE CORPS

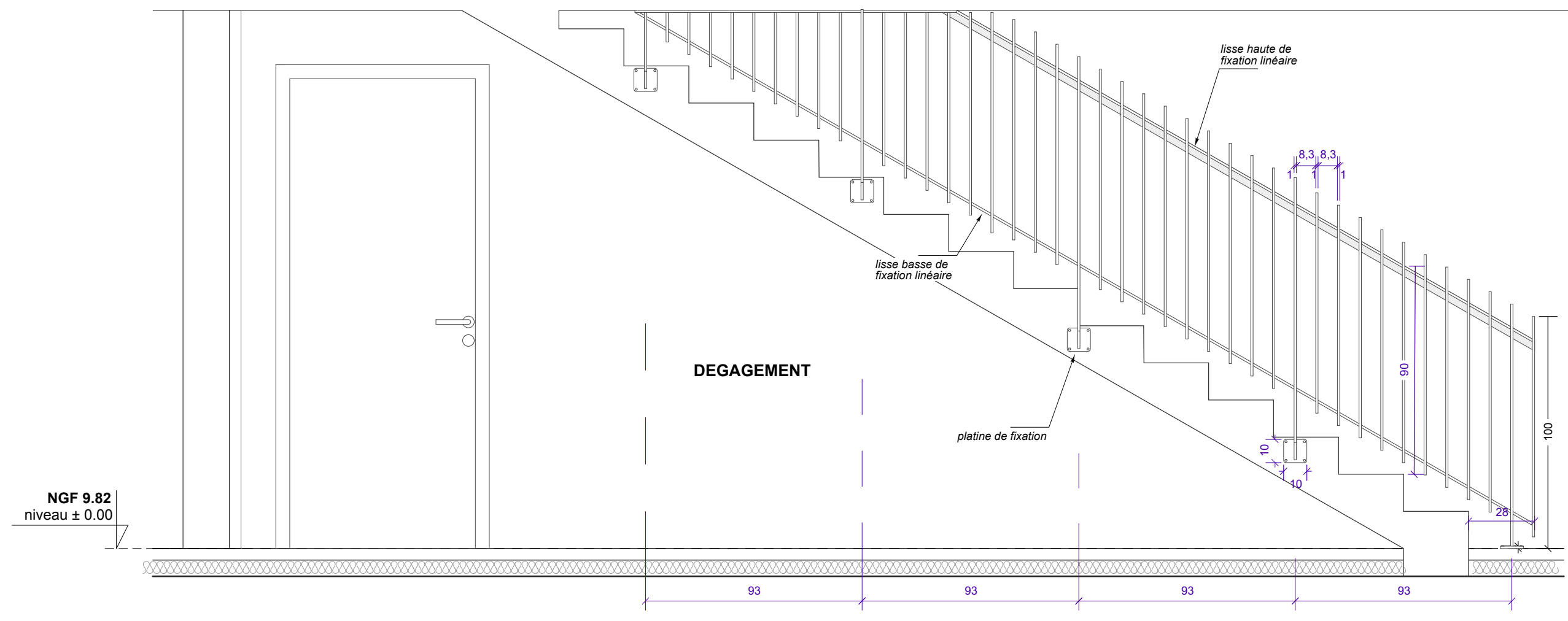
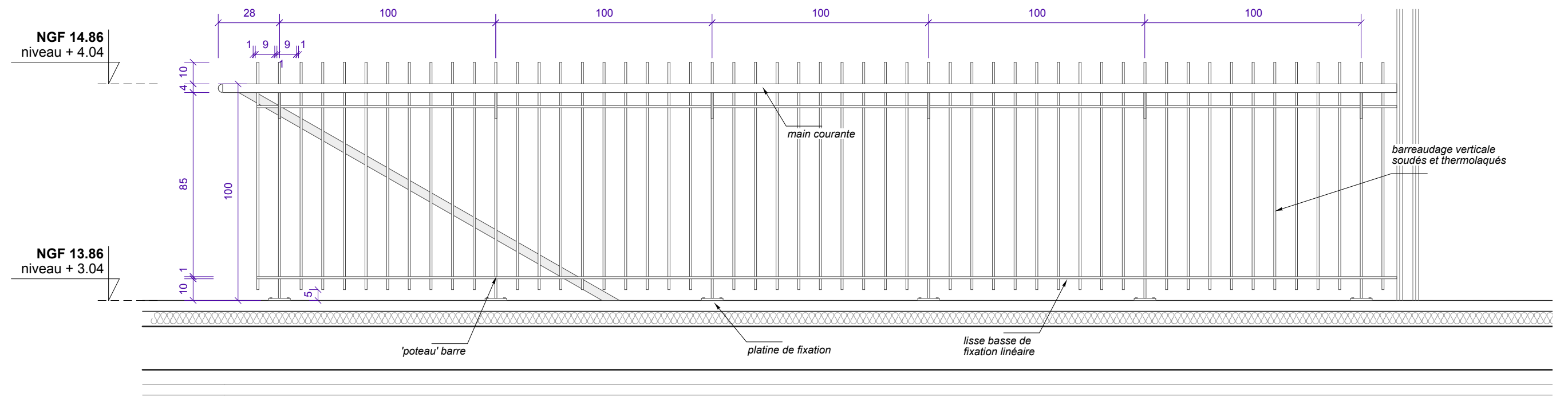

VUE EN LATÉRALE

DETAIL DE PRINCIPE - éch: 1/20
BALCON + GARDE CORPS

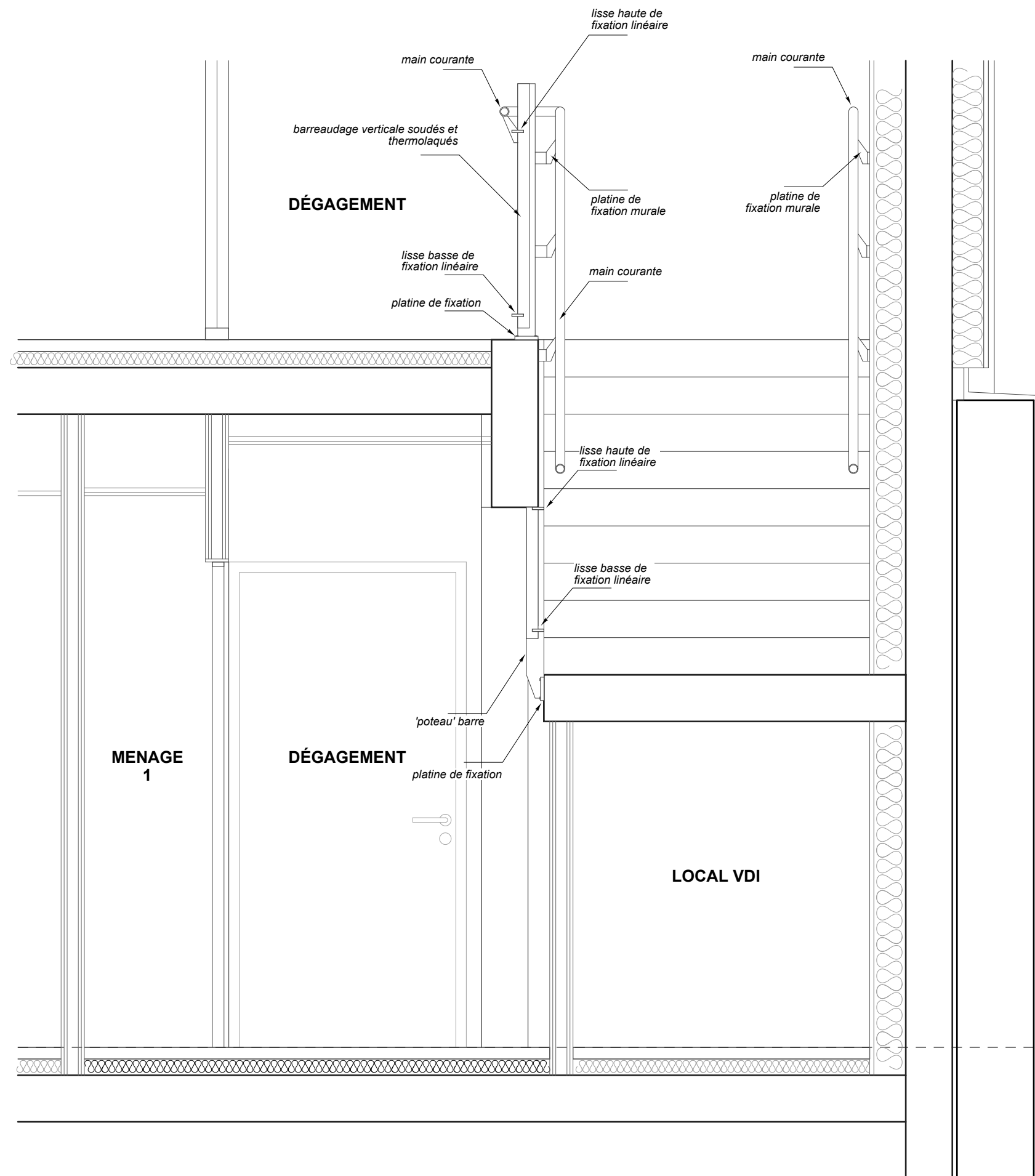

VUE EN COUPE

DETAIL DE PRINCIPE - éch: 1/20
BALCON + GARDE CORPS

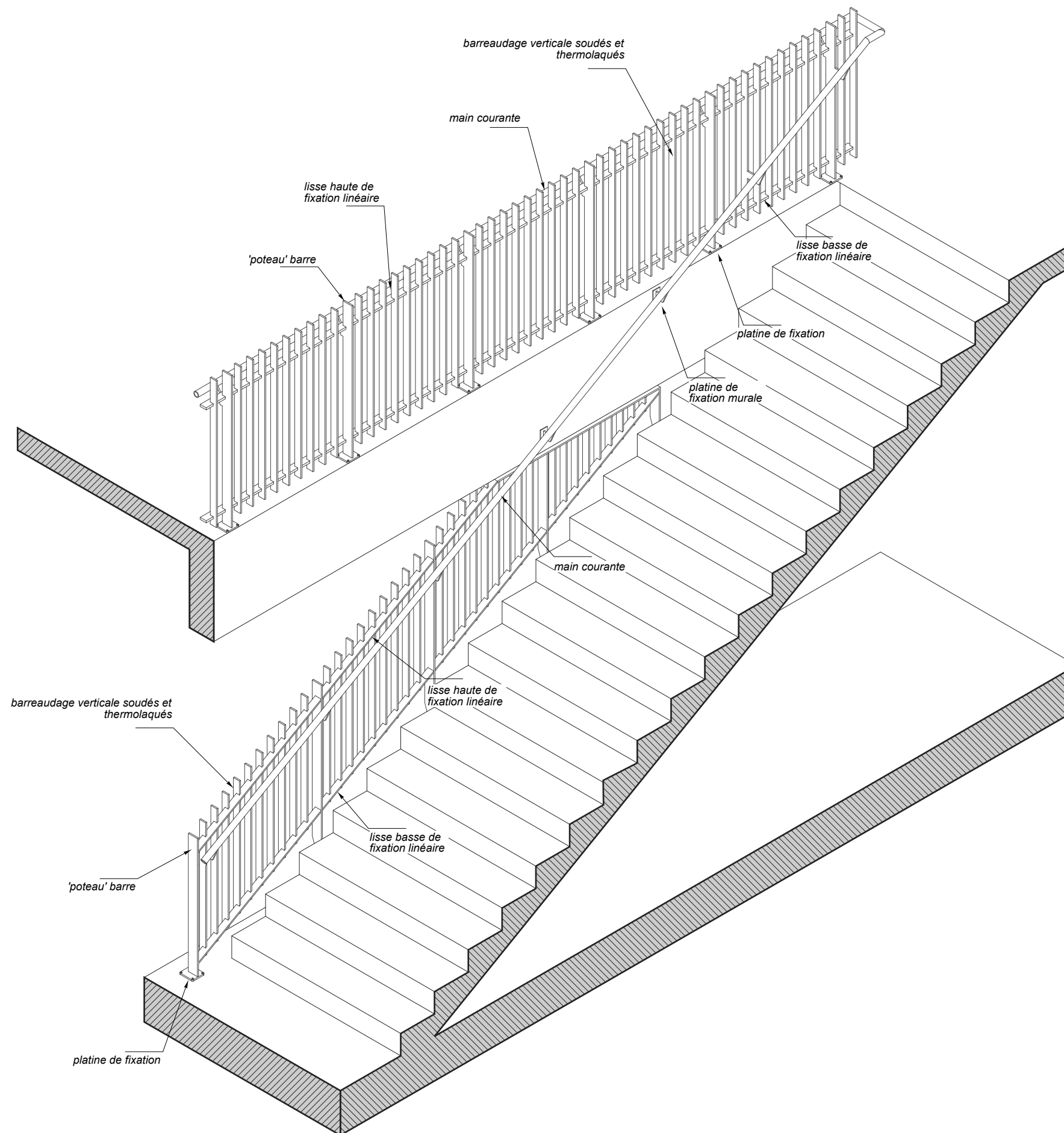

VUE EN AXONOMETRIE

DETAIL DE PRINCIPE
BALCON + GARDE CORPS

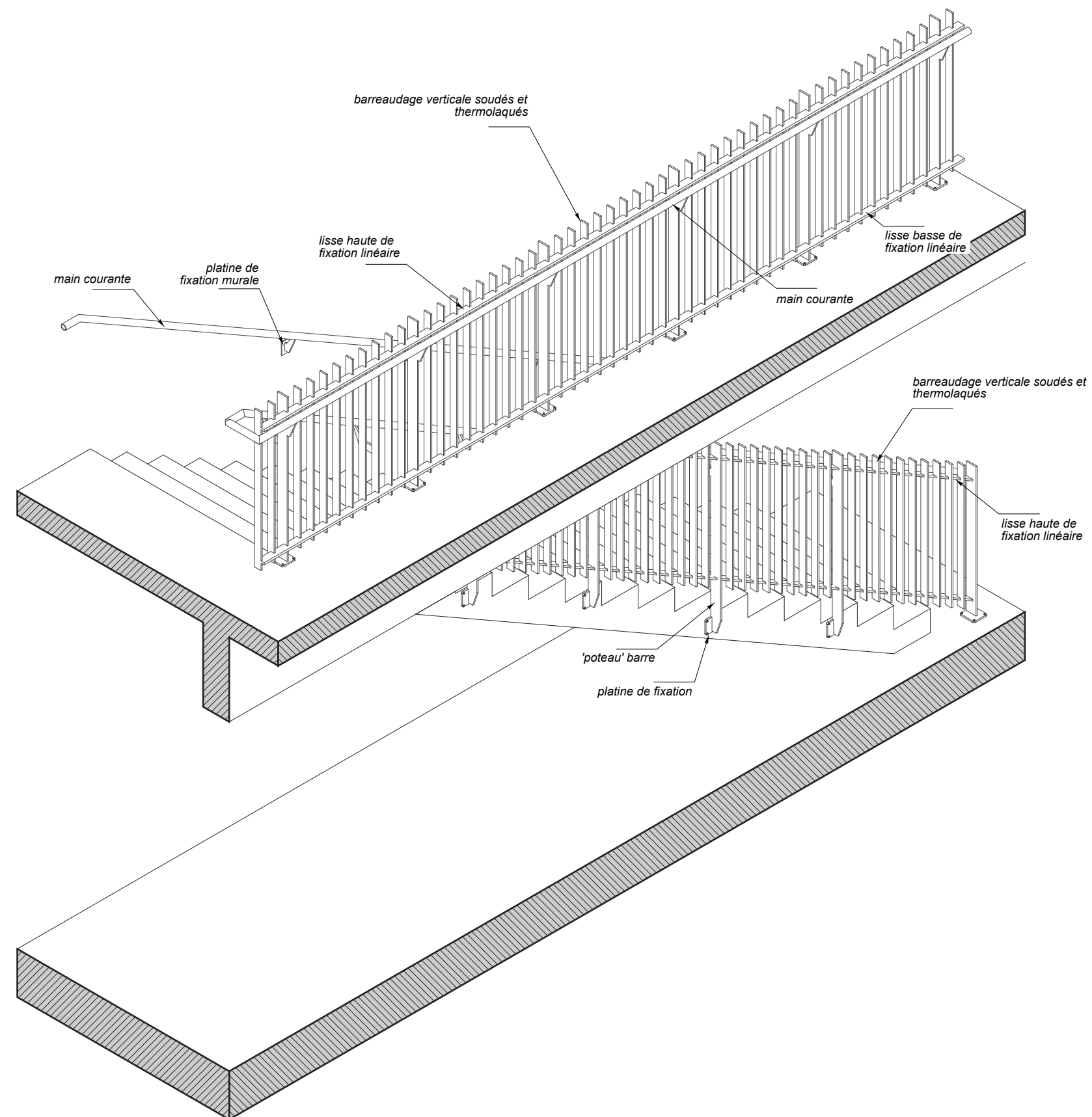

VUE EN AXONOMETRIE

DETAIL DE PRINCIPE
BALCON + GARDE CORPS

Panneau bois multiplis bouleau ép. 22 mm
Finition vernis hydrofuge incolore extramat

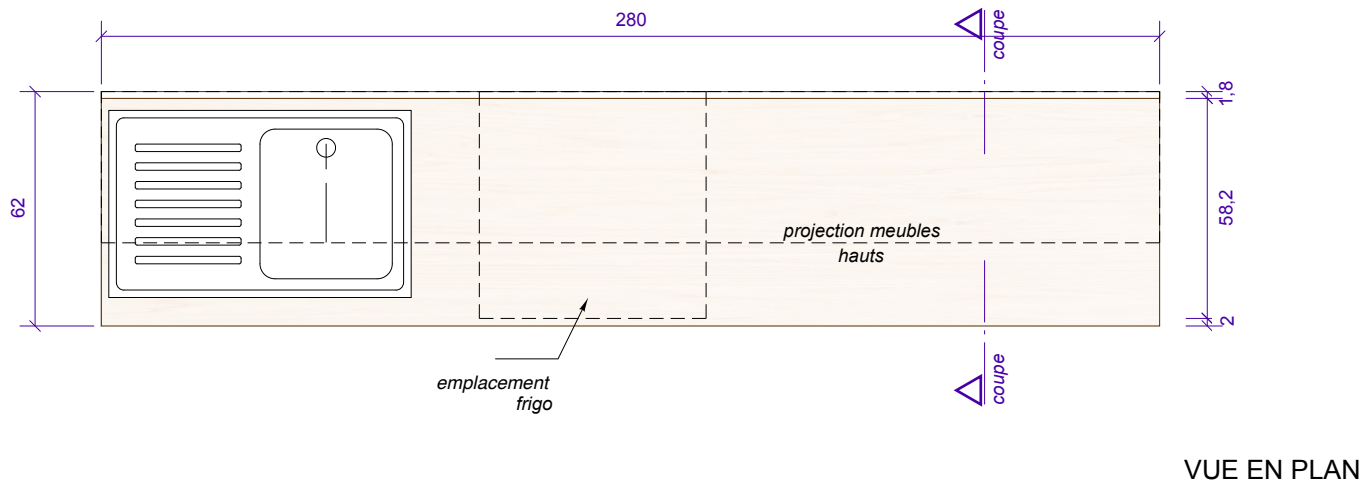
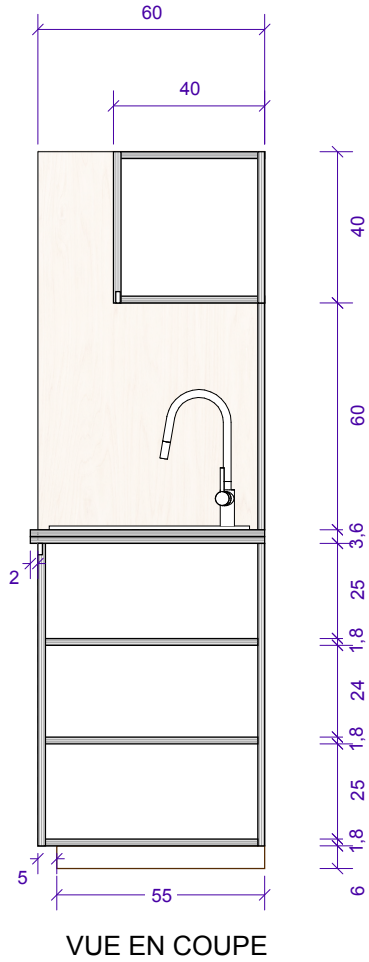
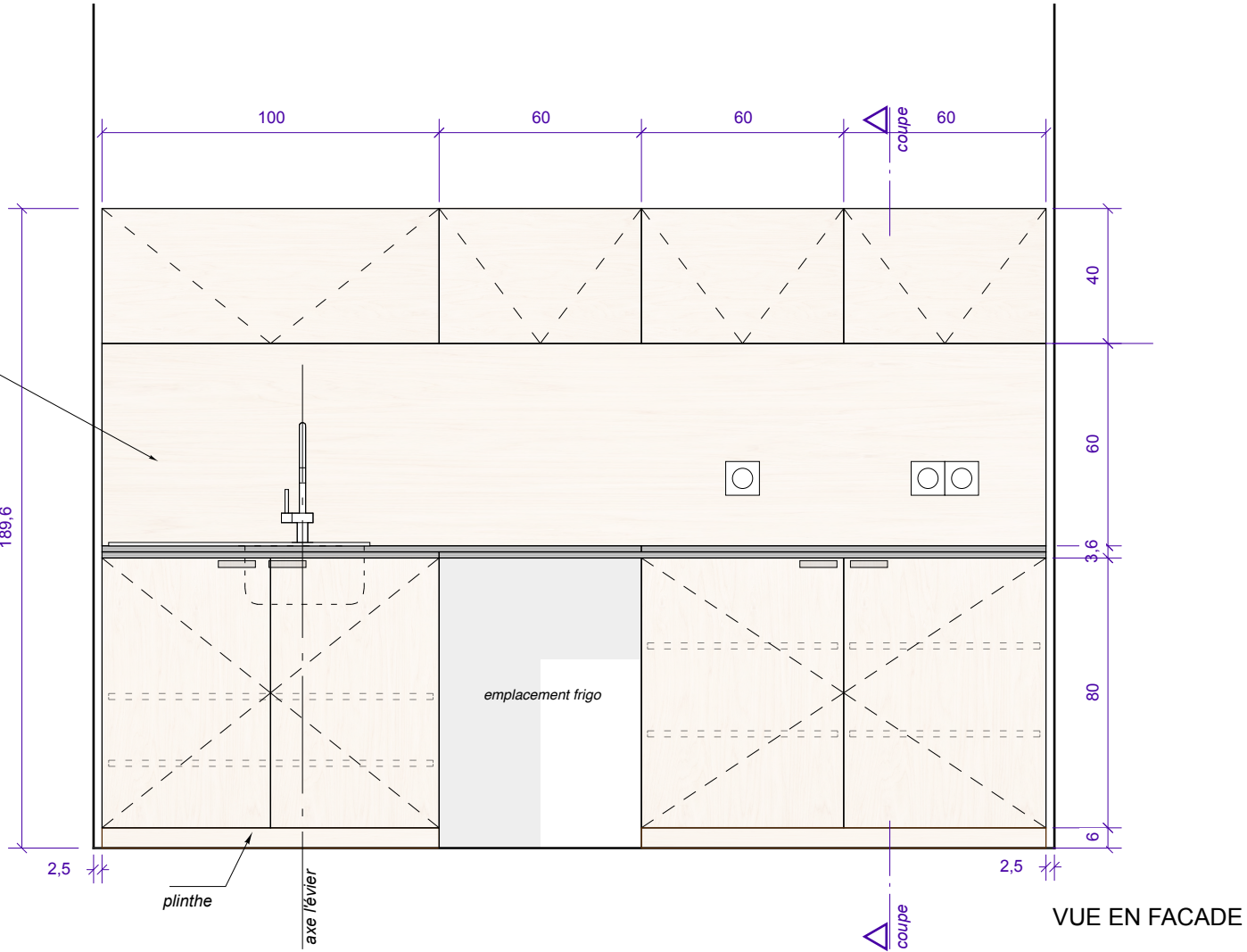

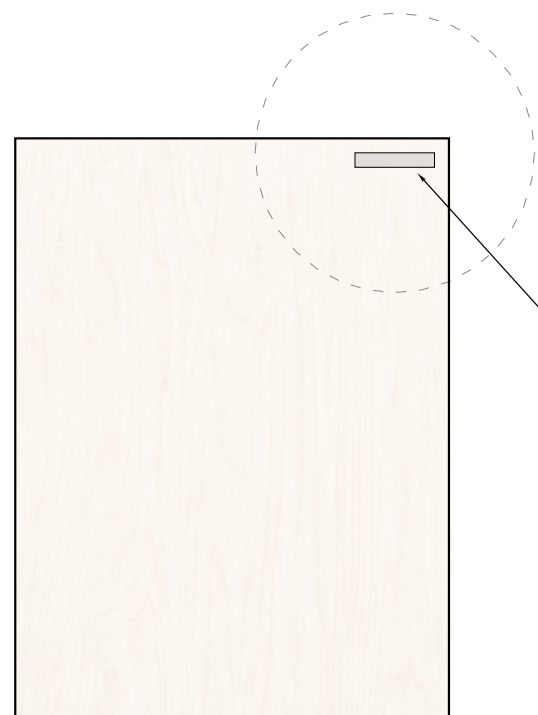
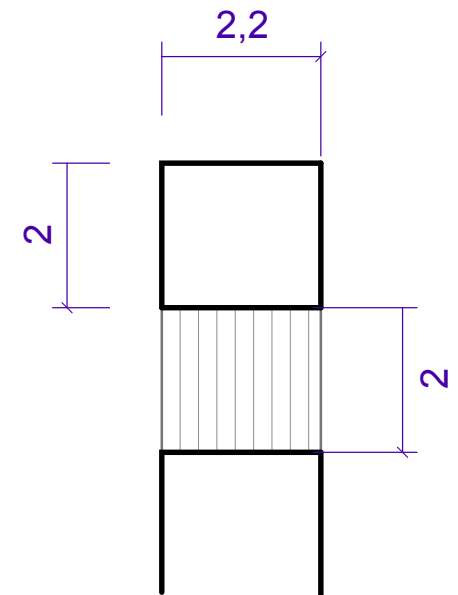
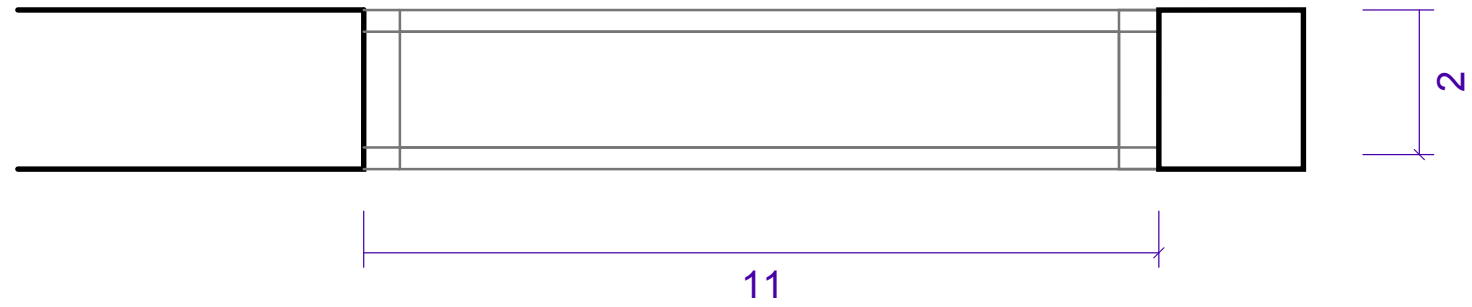

Poignée prédécoupée
Panneau bois multiplis bouleau ép. 22 mm
Finition vernis hydrofuge incolore extramat

DETAIL DE PRINCIPE - éch: 1/1
POIGNEE DE PORTE - MEUBLE BAS

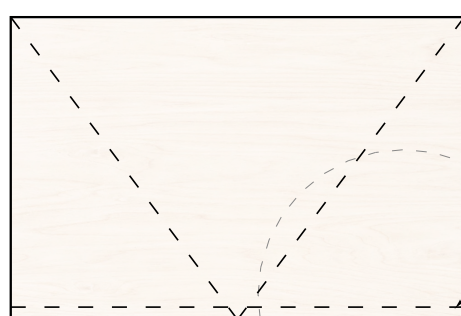
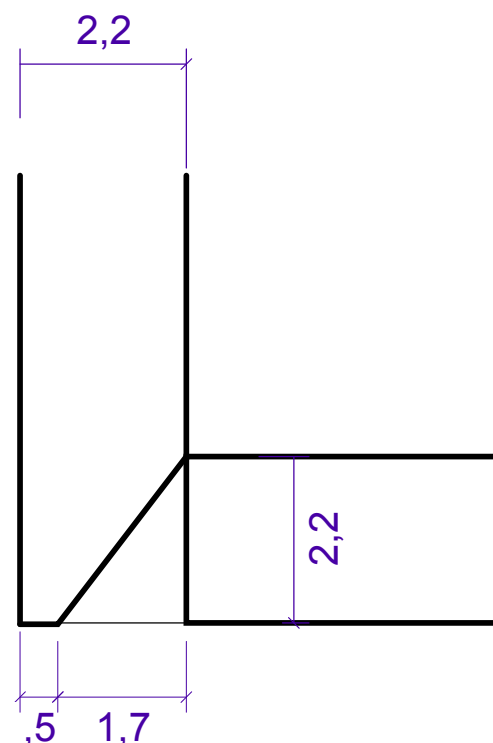
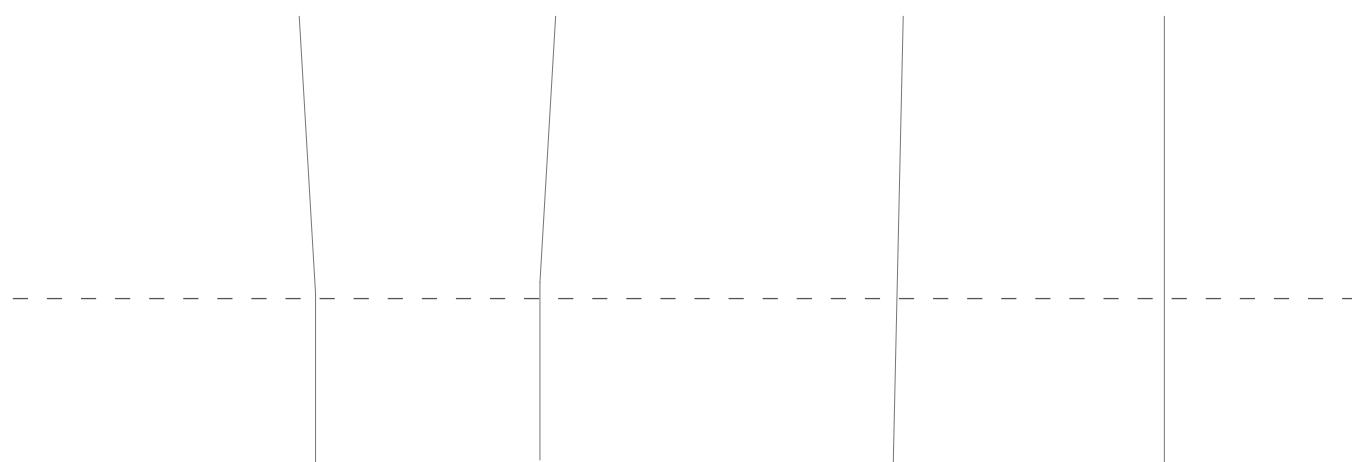

Poignée invisible intégrée prédécoupée
Panneau bois multiplis bouleau ép. 22 mm
Finition vernis hydrofuge incolore extramat

Panneau bois multiplis bouleau ép. 22 mm
Finition vernis hydrofuge incolore extramat

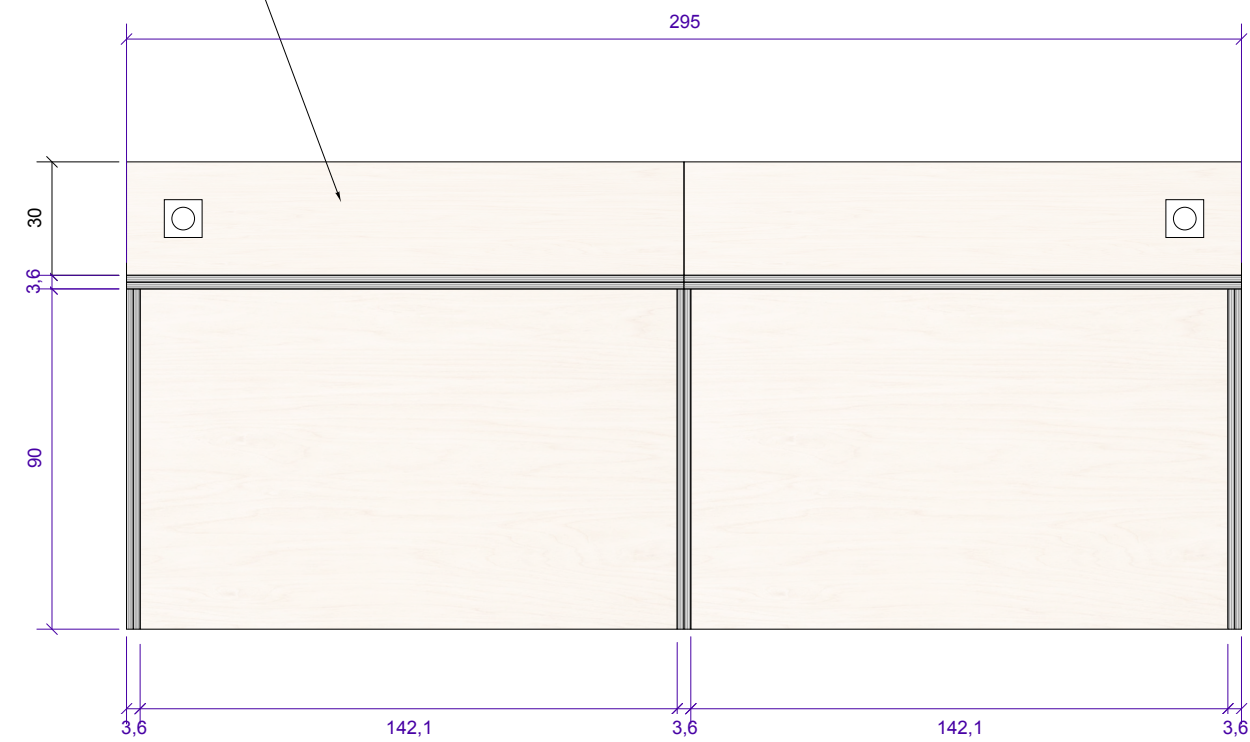

VUE EN FACADE



VUE EN COUPE

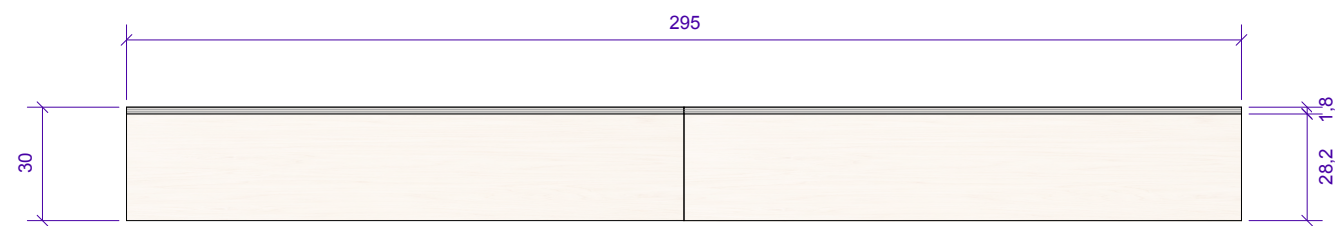

VUE EN PLAN

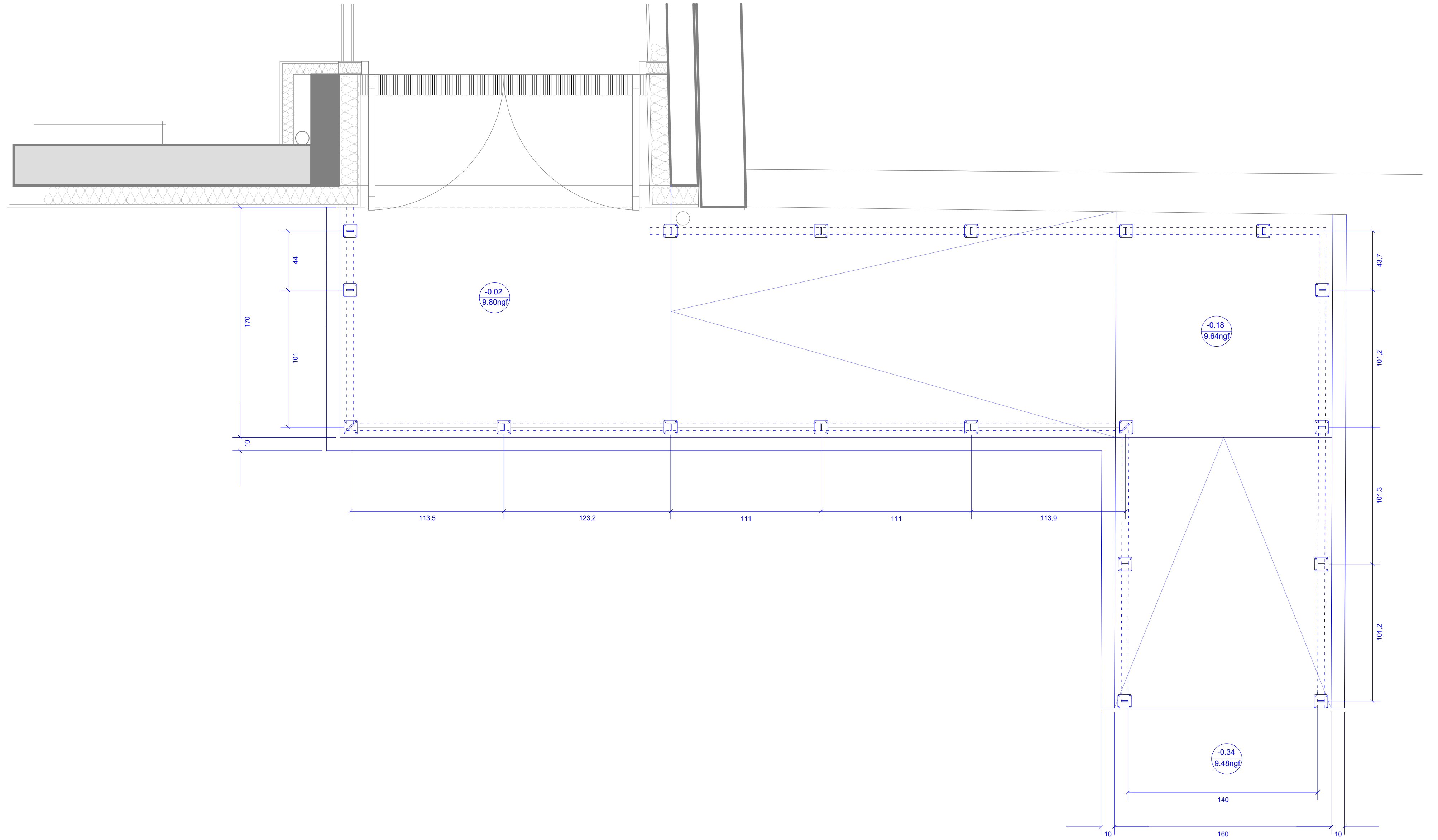
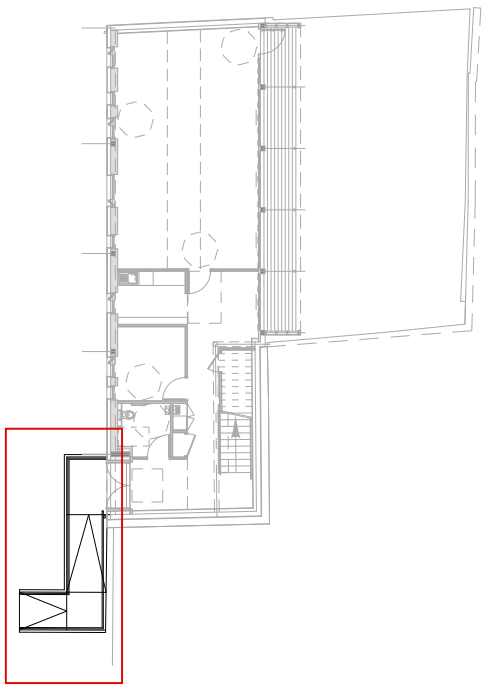

VUE EN PLAN - RDC

DETAIL DE PRINCIPE - éch: 1/20
MAINS COURANTES

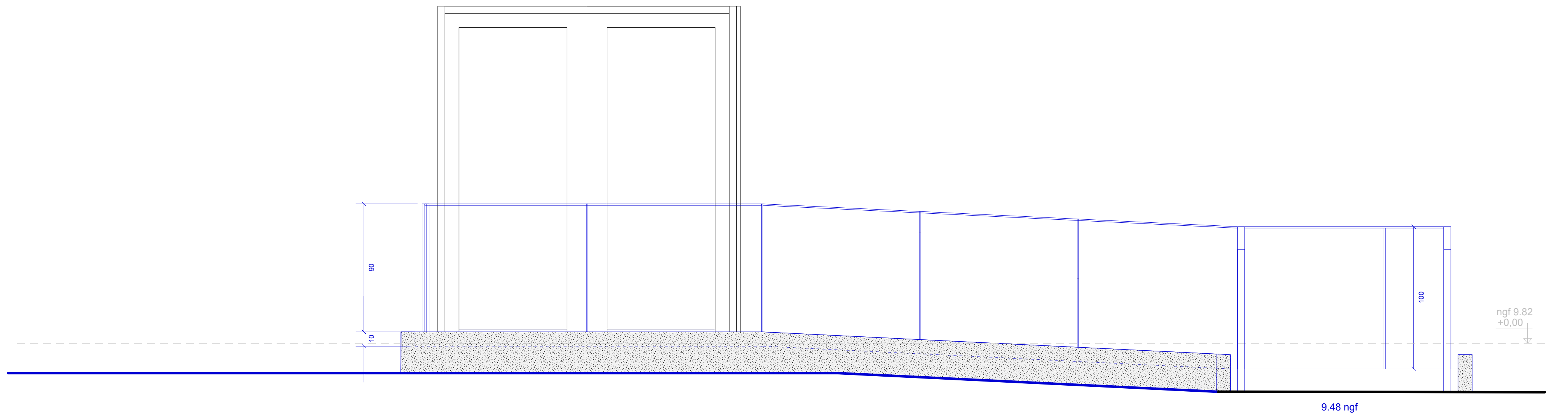

VUE EN LATÉRALE

DETAIL DE PRINCIPE - éch: 1/20
MAINS COURANTES