

## ARCH 02-Carnet de détails

### Nécropole de Lexy (54) Meurthe-et-Moselle

MAÎTRE D'OUVRAGE



**ONaCVG**

Hôtel National des Invalides  
129, rue de Grenelle  
75007 Paris  
marches@onacvg.fr

MAÎTRE D'ŒUVRE

BLP RRC

**BLP RRC**

2 rue Lagrive | BP 493  
51067 Reims cedex  
03 26 49 58 00  
contact@blp-architectes.fr

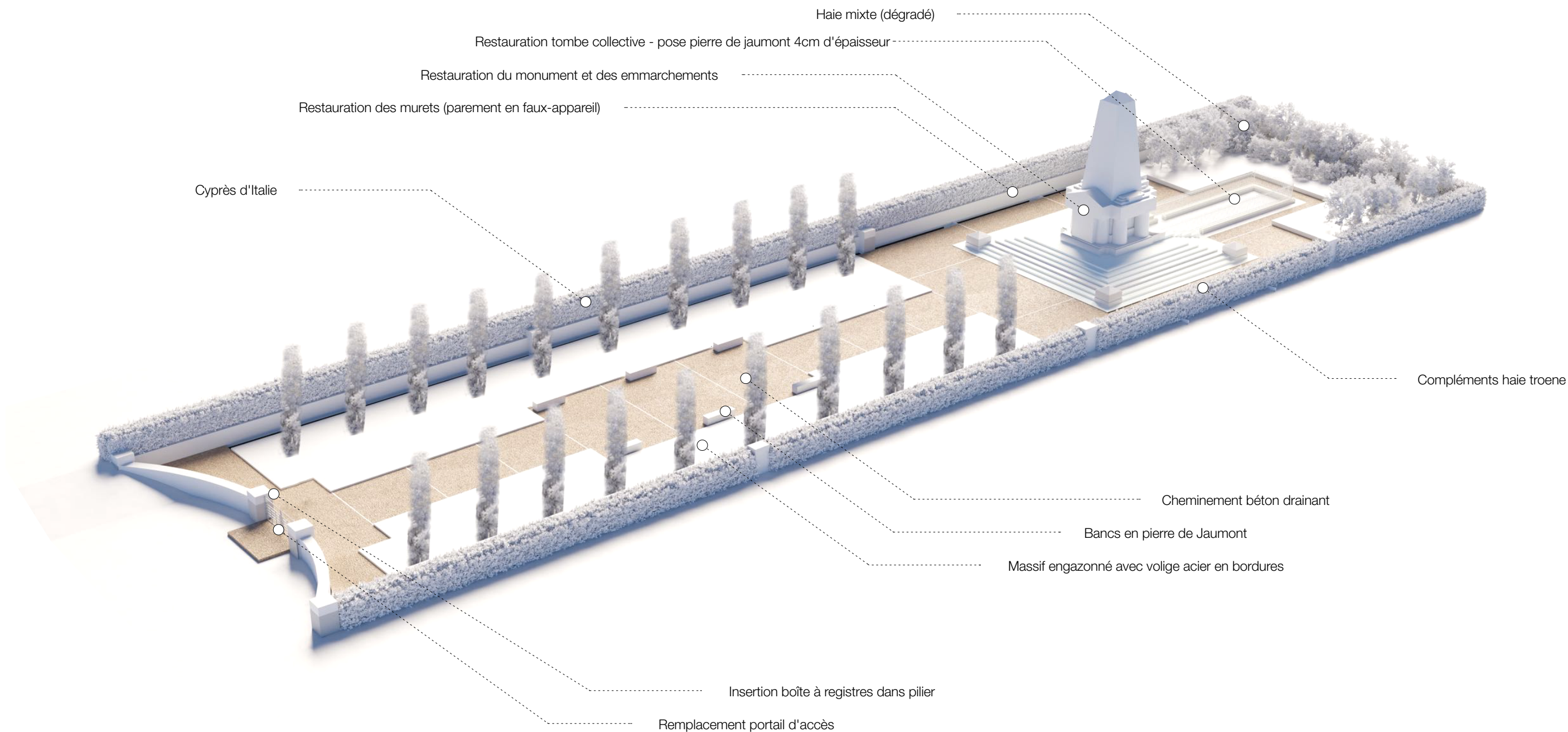

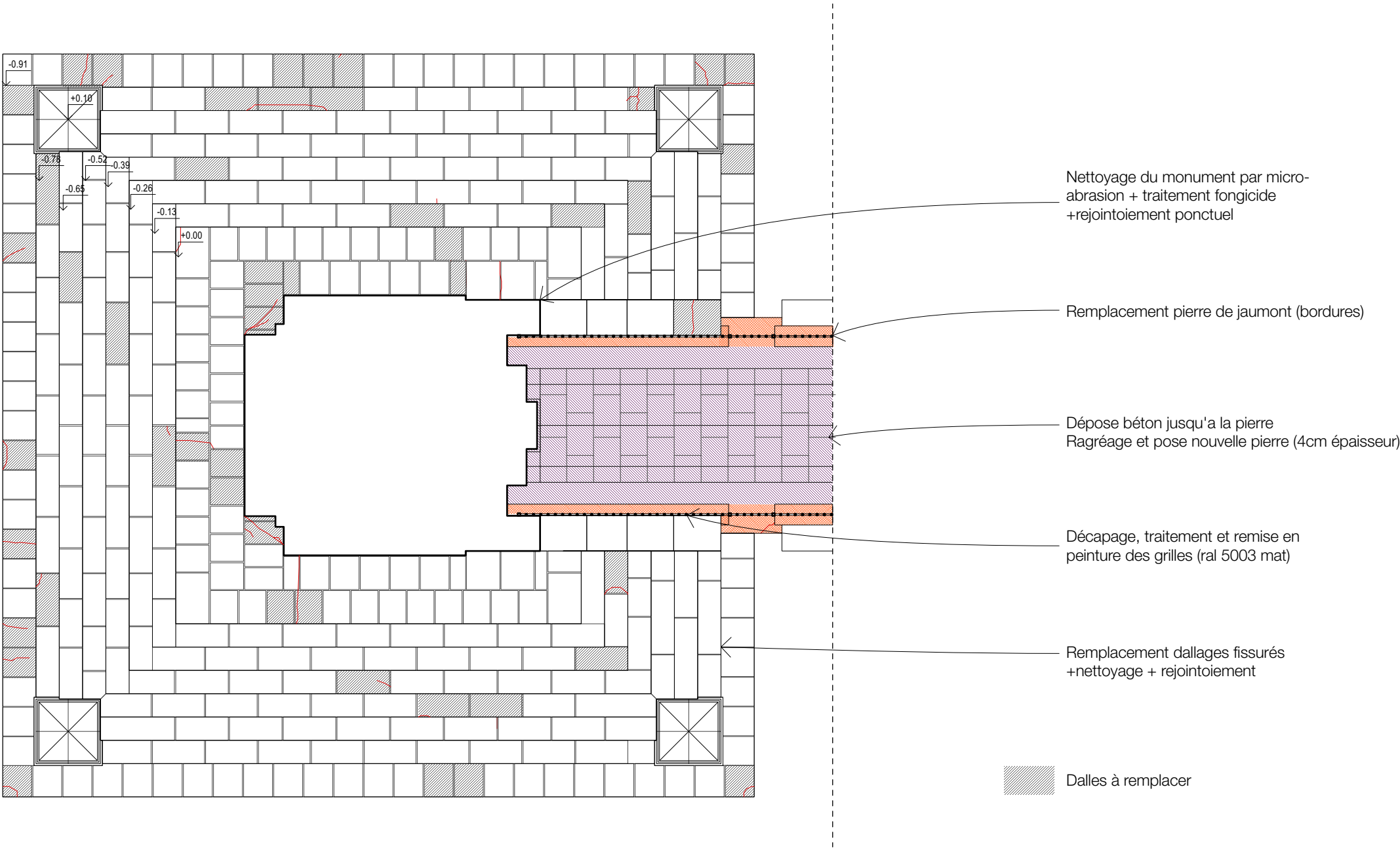

Emmarchement du monument\_Echelle 1.100e

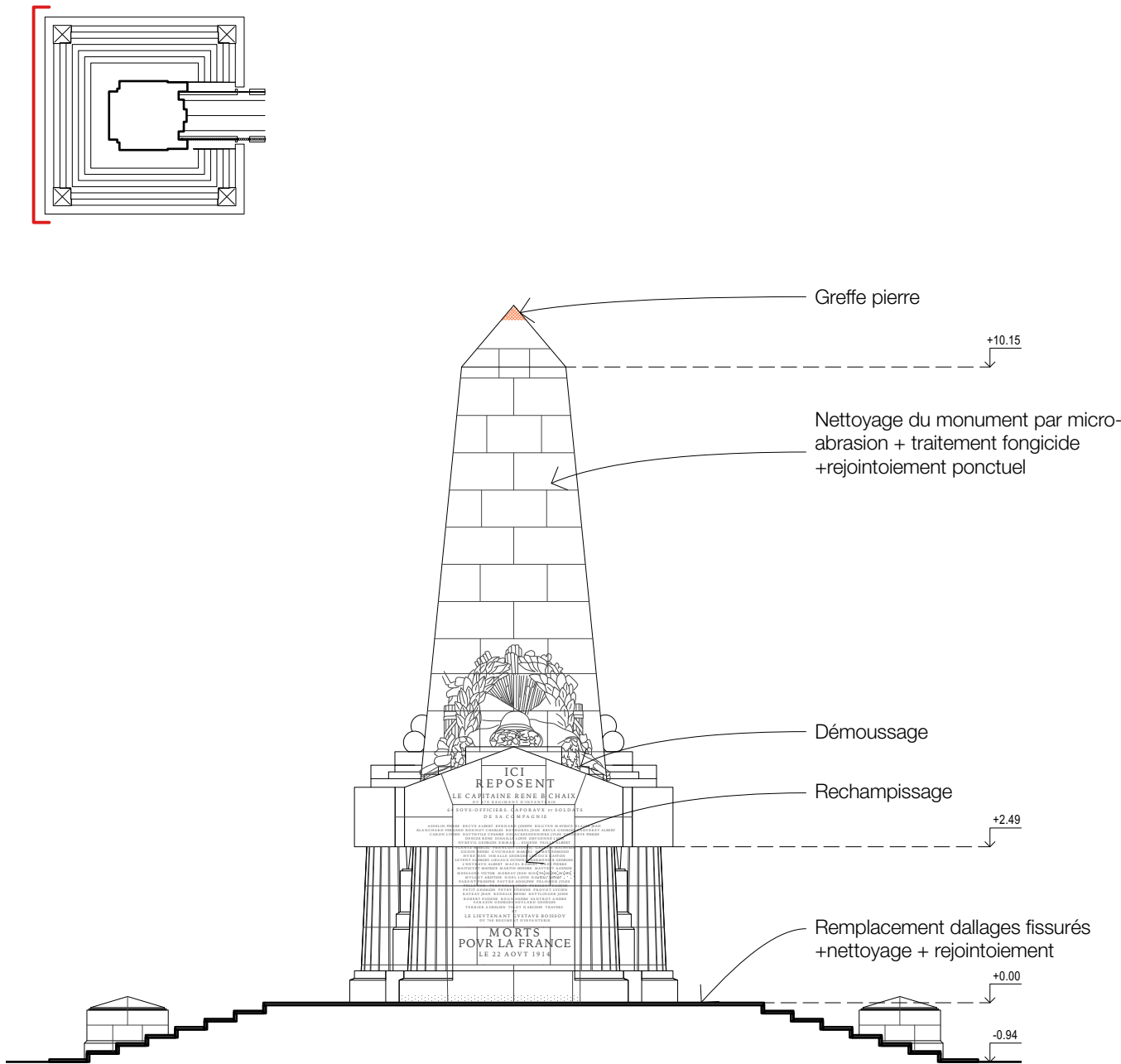

Face Ouest du monument\_Echelle 1.100e

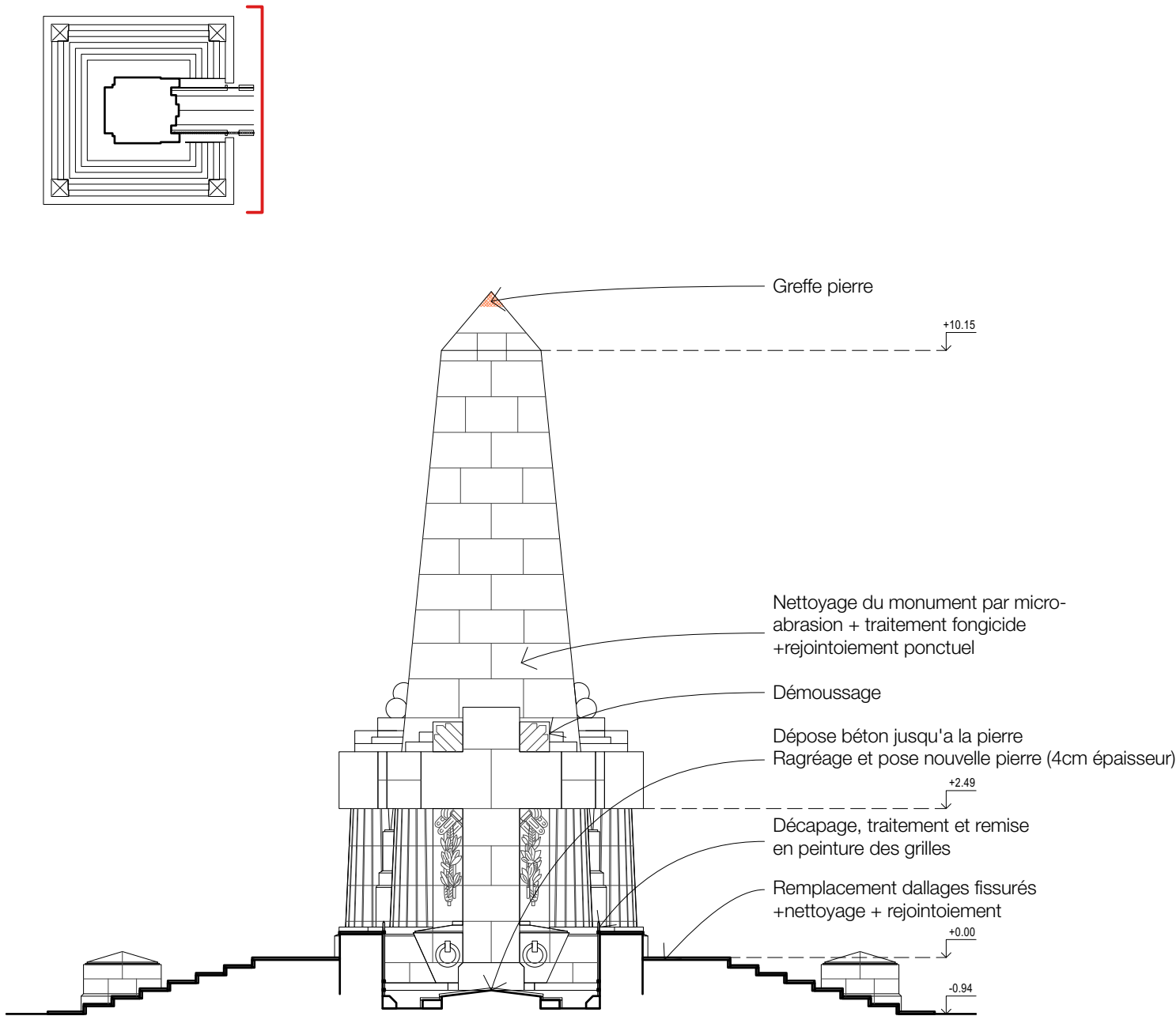

Face Est du monument\_Echelle 1.100e



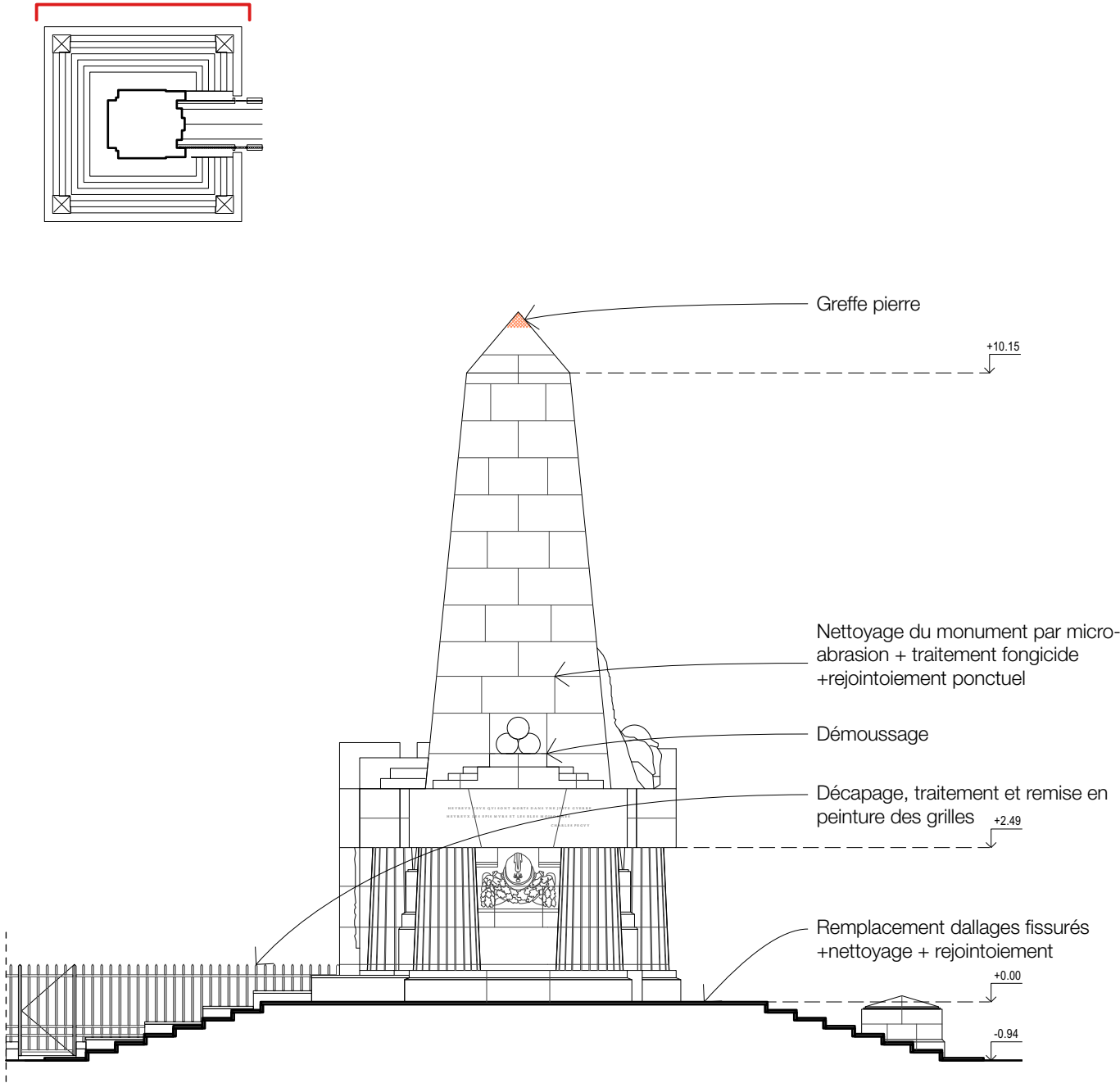

Face Nord du monument\_Echelle 1.100e

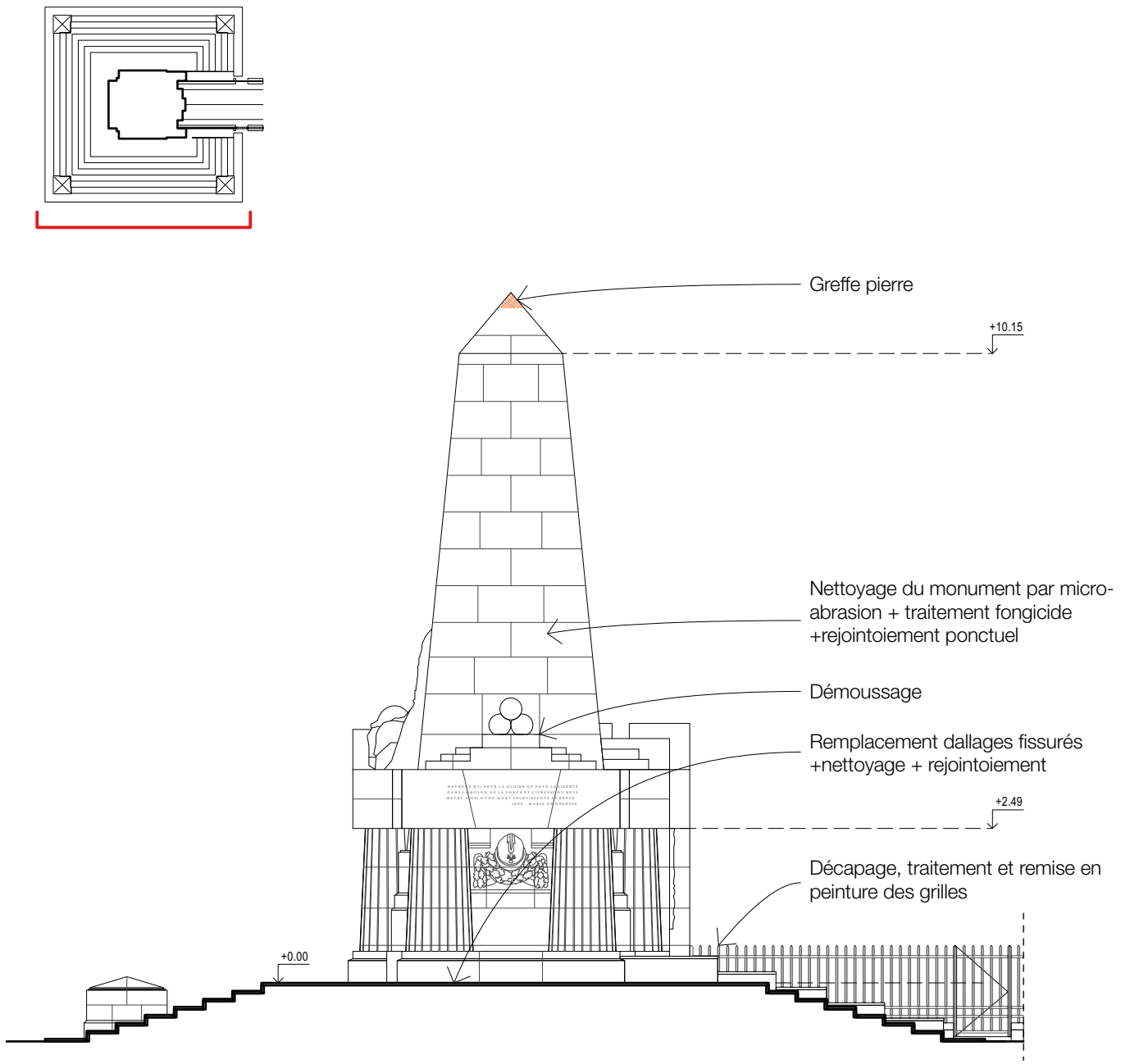

Face Sud du monument\_Echelle 1.100e

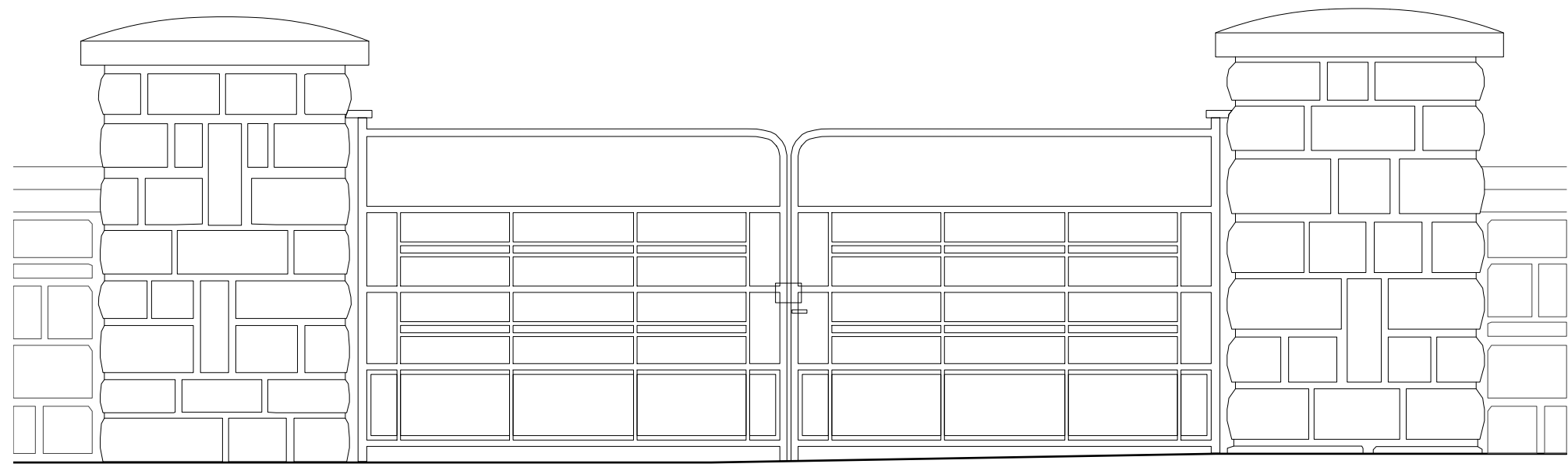

Portail d'accès\_État existant\_Echelle 1.25e

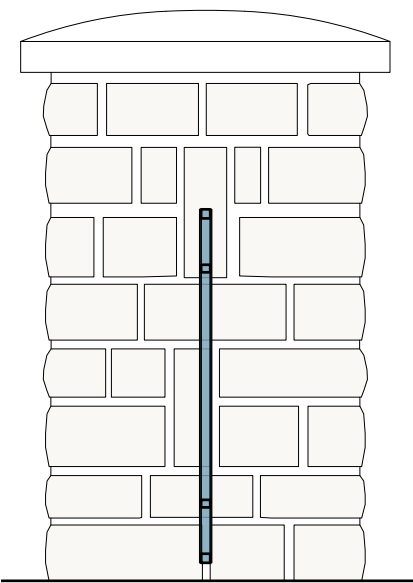
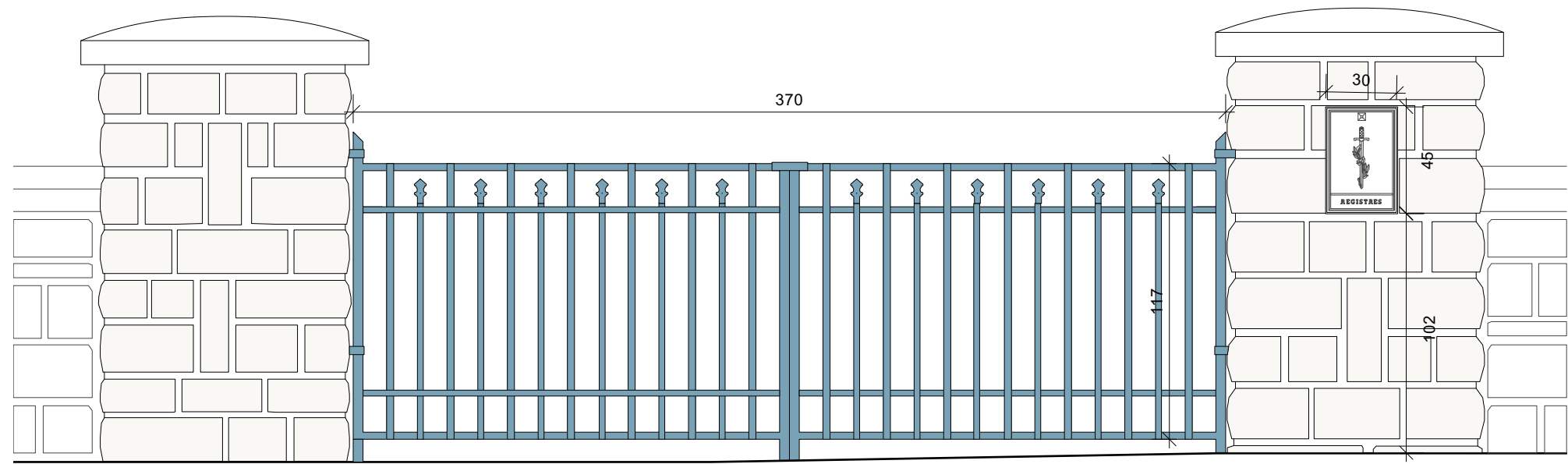

Portail d'accès\_État projeté\_Echelle 1.25e

insertion boîte à registres

